

Chief Specification
 Roof: Mono pitched.
 Floor Loading: 2.5kn.
 Ceiling Height: 2.35mm.
 Steel Fascia.
 Insulated 100mm to walls, floor & roof

External Finishes/Texture
 Body colour & Corners 14C39
 Fascia & Jacklegs:
 Gloss painted Black
 Timber door frame: Black
 Door: Gloss painted: 14C39
 RWP: Black

Internal finishes
 Walls: White polyply pre-finished lining. Ceiling: White pre-painted plywood.
 Floor: Marley 1.5 vinyl BLUE FL57 Gention.
 Skirting Black PVC.
 Windows: Alum. H/L FOS, 600w x 300h Obscured glazing.
 Windows c/w T2 mesh guards, CSI height 1721 off.
 Timber Architrave & window lining: Donkey Brown.
 H/L Fan heaters c/w thermostat.

DO NOT SCALE OF DRAWING
 Fleet No:
 Production No: 5912
 Timber - Texture
 Framing: 57mm

Fittings:
 Paper towel dispensers to both rooms.
 Light Wood toilet seat to female wc only

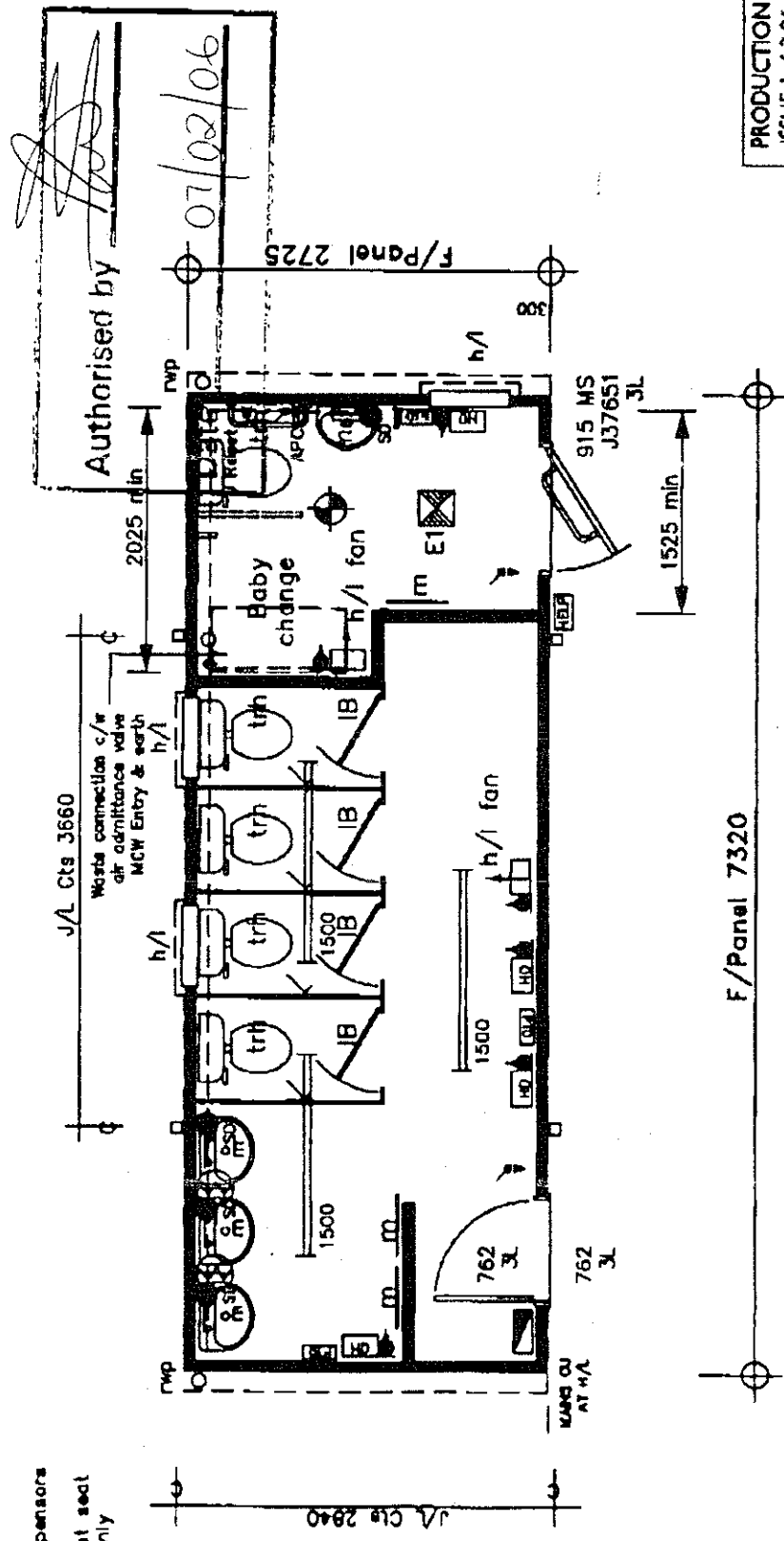

PRODUCTION
 ISSUE 1 6.2.06

Date: 18.10.05
Drawn: B.M.
Scale: 1:50
Rev:
Proj No: 05.8622.2
Rev:
 A: Door altered 23.01.06
 B: Colours, notes 6.2.06

Title: Female toilet unit c/w disabled 7.3m x 2.7m
Client: Timber jackleg unit. 2000 Range.

Wernick Hire Ltd

THE COMPLETE HIRE SERVICE FOR PORTABLE BUILDINGS